

REVISIONS				
DRWN	DATE	CHK'D	REV	DESCRIPTION
CR	11DEC17		A	PRELIMINARY RELEASE
CR	12/20/2017		B	AS BUILT

D
C
B
A

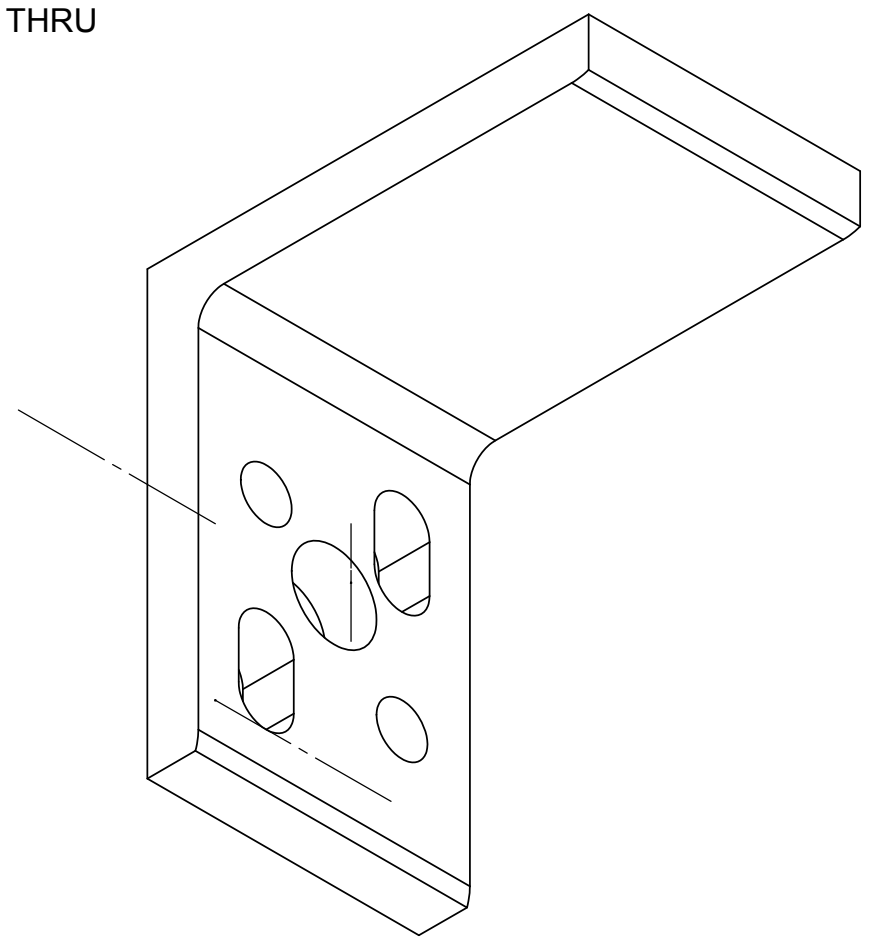
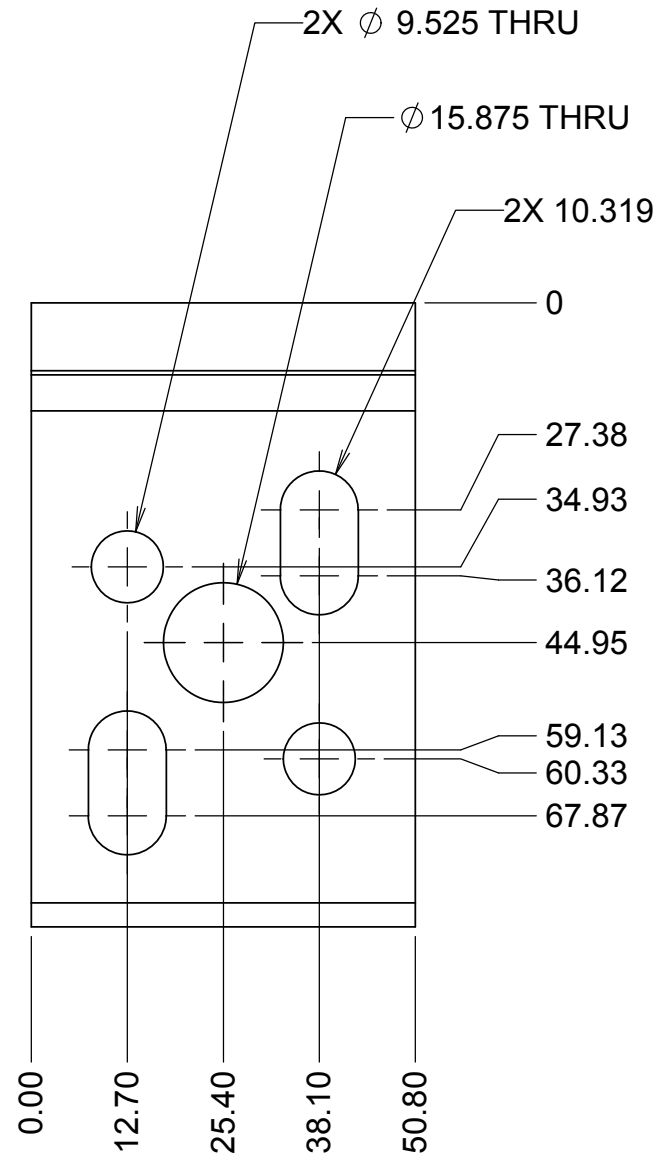
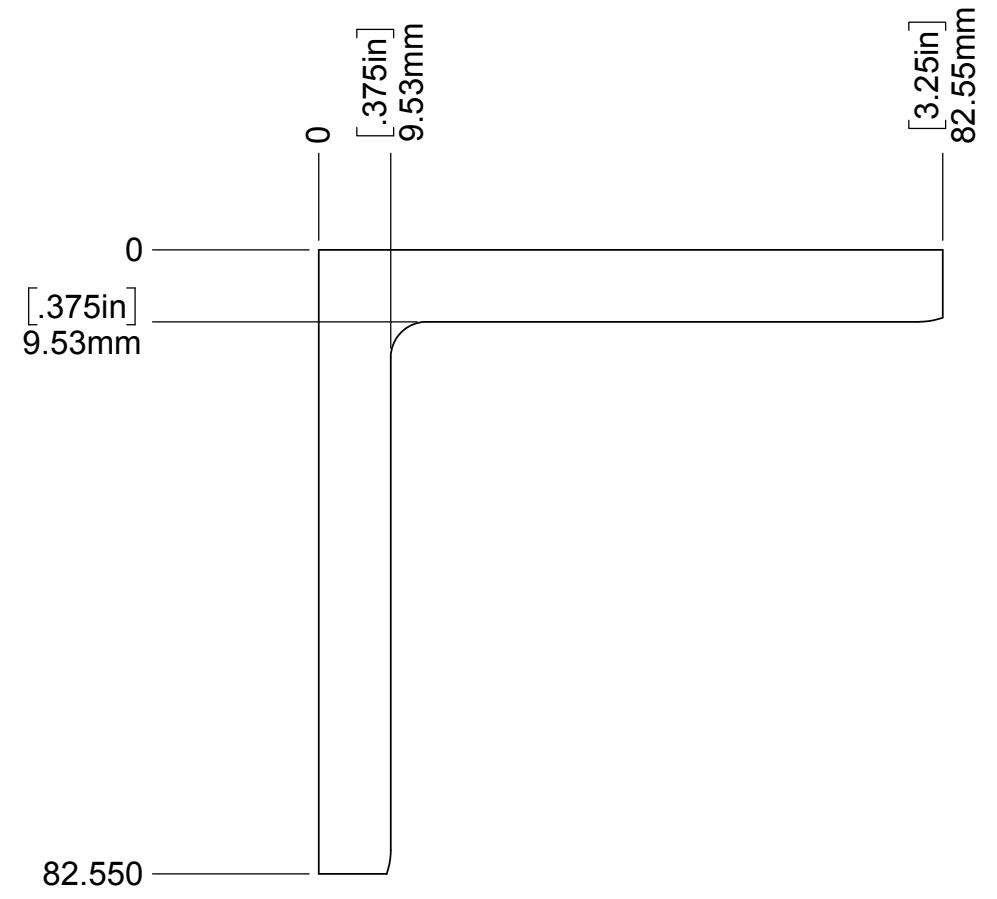

NOTES

- CAD MODEL FILENAME, 872-LM3188 Seismic Restraint B
- MATERIAL: 1020 STEEL OR SIMILAR, USE APPROPRIATE ANGLE STOCK AS RAW MATERIAL
- BREAK ALL SHARP EDGES
- PAINT BLACK WITH BEST KNOWN UCO METHODS
- DRILL DETENT PIN HOLE ON SITE, USE TRANSFER PUNCH TO SET LOCATION

UNLESS OTHERWISE NOTED DIMENSIONS ARE IN MILLIMETERS & TOLERANCES ARE AS FOLLOWS: X.X: ±0.10 mm X.XX: ±0.05 mm ANGLES: ±0.5° FINISH: 3 MICRONS (µm) BREAK ALL SHARP EDGES & CORNERS .25mm MAX	
MATERIAL SEE NOTES	FINISH

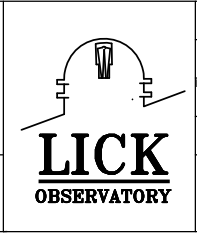

DESIGNED C. RATLIFF ENGINEER	CHECKED DM	PROJECT CODE K1D3FD	DWG NO 872-LM0000	REV B
QUANTITY 1	TITLE SEISMIC RESTRAINT B	PROJECT CODE K1D3FD	DWG NO 872-LM0000	REV B
SW DOCUMENT FILE 872-LM3188 Seismic Restraint B	QUANTITY 1	PROJECT CODE K1D3FD	DWG NO 872-LM0000	REV B
TITLE SEISMIC RESTRAINT B			DWG NO 872-LM3188	REV B

KECK 1 DEPLOYABLE TERTIARY MIRROR

OUTER DRUM

SEISMIC RESTRAINT B

8 7 6 5 4 3 2 1